

AUX.VIEW
SCALE:2X

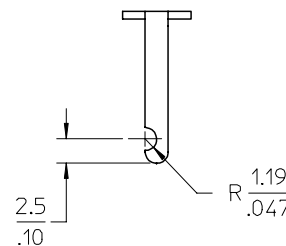
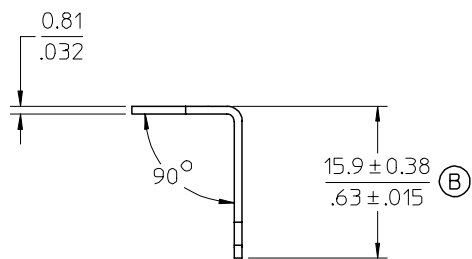

NOTES:

- 1. MATERIAL: SEE TABLE
- 2. FINISHES: SEE TABLE
- Ⓑ 3. PART IS ROHS COMPLIANT.

| 1 | 1 | TERMINAL | BRASS | TIN PLATED |
|------|------|-------------|----------|------------|
| ITEM | QTY. | DESCRIPTION | MATERIAL | FINISH |

| | | | | | | | | |
|--|-----------------|---------------------------------------|-------------------------------|-----------------|---|------------------------|---|--|
| CHANGE DIM/ADD NOTES EC NO: ETC2007-0438 DRWN: CLYORK 2007/07/12 CHKD: JMACNEIL 2007/07/12 APPR: JMACNEIL 2007/07/13 | QUALITY SYMBOLS | GENERAL TOLERANCES (UNLESS SPECIFIED) | | SCALE 2:1 | DESIGN UNITS INCH | THIRD ANGLE PROJECTION | REVISE ON CAD ONLY | |
| | ▼ - 0 ▽ - 0 | 4 PLACES | ± --- | ± --- | DIMENSION STYLE MM/IN | | TITLE TERMINAL, SOLDER, Y SHORT, CAT. # 143 | |
| | | 3 PLACES | ± --- | ± .005 | DRAWN BY R.STONE | DATE 08-18-03 | | |
| | | 2 PLACES | ± 0.13 | ± .01 | CHECKED BY RK | DATE 2-5-04 | MATERIAL NO. 380020159 | |
| | 1 PLACE | ± 0.3 | ± --- | APPROVED BY GHR | | DATE 2-26-04 | DOCUMENT NO. SD-38002-005 | |
| | ANGULAR ±1/2° | | DRAFT WHERE APPLICABLE | | SHEET NO. 1 OF 1 | | | |
| | | | MUST REMAIN WITHIN DIMENSIONS | | THIS DRAWING CONTAINS INFORMATION THAT IS PROPRIETARY TO MOLEX INCORPORATED AND SHOULD NOT BE USED WITHOUT WRITTEN PERMISSION | | | |